

# Roadpost Support Center

Portal > Knowledgebase > GeoPro > GeoPro Web App > Web App for Administrators > Filter Tab > How-To > Filtering by Tenant or Group using the Filter tab [GPv3]

## Filtering by Tenant or Group using the Filter tab [GPv3]

Lu Parente - 2015-10-07 - in How-To

The **Filter** tab provides Administrators and Monitors with the ability to filter what is being displayed throughout the entire web app experience. When filters are used, they are applied to the Map, the Home tab, Devices tab, List View tab and Options tab. Filters are used to focus on specific criteria or a combination of criteria such as a **tenants/sub-tenants** or **groups, devices, device state,** and **message date.**

This article explains how to **filter by tenant or group.**

1. To filter by tenant or group, navigate to the **Filter** tab.

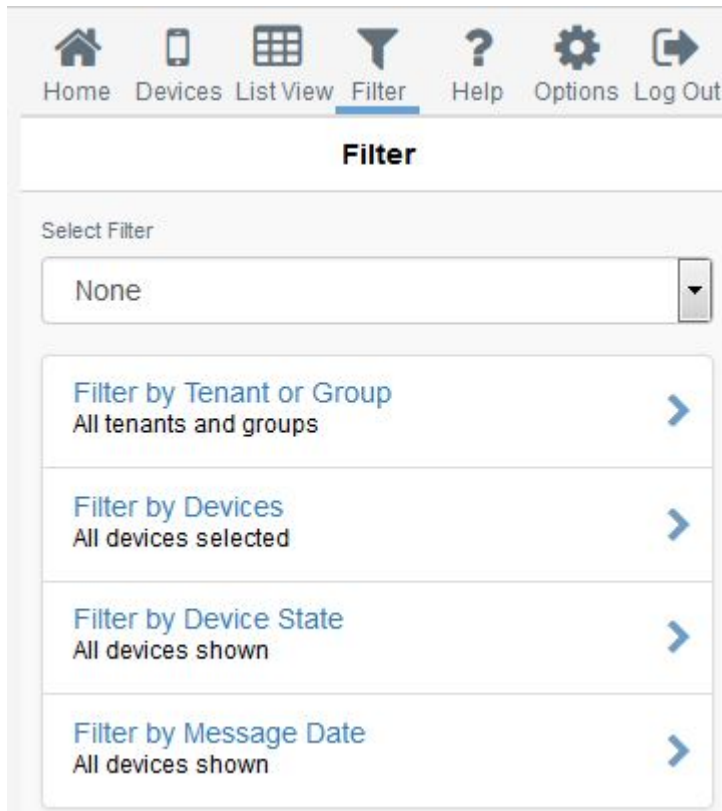

2. The filtering options will be displayed. Select **Filter by Tenant or Group** from the list.

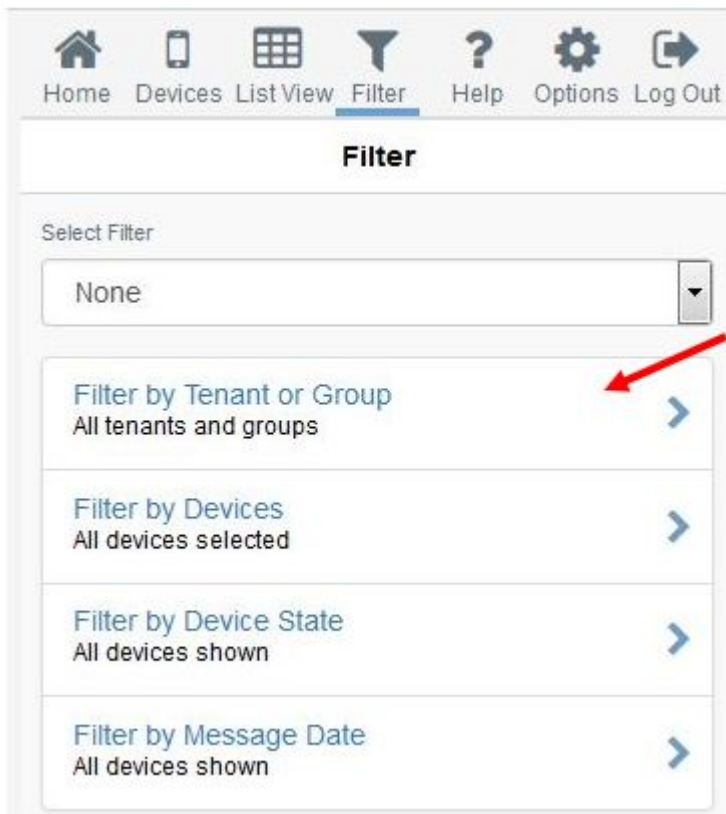

3. From the drop-down, select the **tenant** or **group** you would like to focus on. Both tenants and groups will be displayed in the drop-down however groups will be *italicized* and indented.

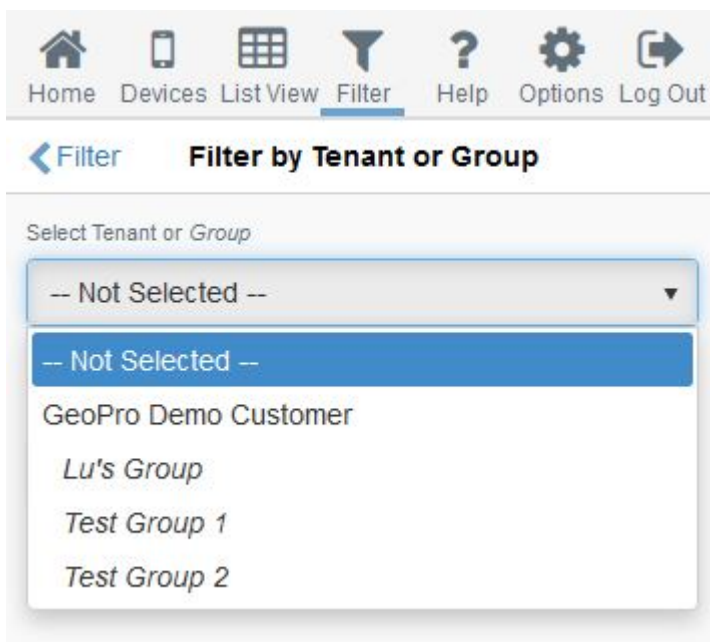

4. Once you've selected the desired tenant or group, press **OK** to apply your filter.

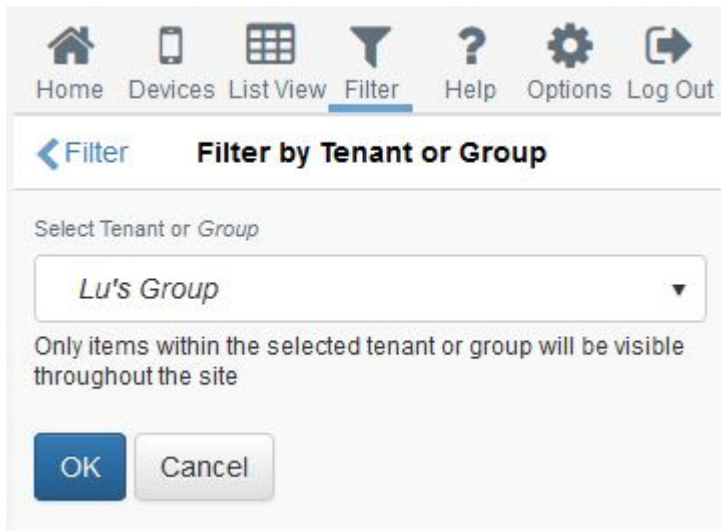

5. Your filter will now be applied to the map and throughout the entire web app as well as the "i" indicator will appear on the **Filter** tab to confirm the filter is active.

